



Nelson & Nelson Mfg.
5210 Stadium Blvd, Suite C
Jonesboro AR 72401
870-268-6393 : Cell 870-219-1019

Installation Instructions 11-4-25

Model SRT-24-BCAM

2024+ F3,RT & Canyon Backup Camera Kit

Steps needed to install your 2024+ Backup Camera Kit.

Tools Needed for this job.

T-15 wrench

T-20 wrench

7/32 socket and driver

10mm socket and driver

Wire cutters / small screwdriver / optional pushpin puller



1.- This installation is on the RT Limited model. The F3 model, the camera plug is under the trunk or F3T back cover. Follow these steps to continue. To Install your new backup camera system, you first need to verify that your 2024+ Spyder has this feature enabled by the latest software update. You need to go to "preferences" and then scroll down to "Backup Camera". If that is turned on you can check the system by starting the Spyder and place it in reverse and you should see a backup screen with lines but a blue screen that shows you do not have a camera installed.

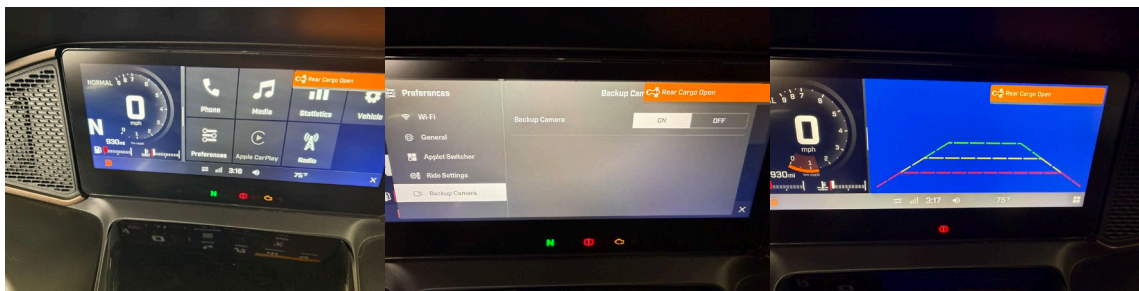

2.- Next remove the rear trunk by using the OEM key to unlock the center lock located at the bottom of the trunk. Once the lock is removed lift up and under the front of the trunk is released to allow the trunk to lift off. To take the trunk off once released lift up and pull back on the trunk. Once removed you will see two arms on the front of the trunk that have two U-Shaped slots that the arms rest in when installed. Make sure to unplug the trunks wiring harness. You may want to remove the passenger seat first depending on whether you have passenger armrest. When removing the rear passenger seat lift up the driver's seat and look under the seat to the front of the passenger seat and located these two tabs shown below and press those in to remove the seat. Be sure to disconnect the seat wire from its plug if installed from factory.



3.-With the seat & trunk removed take T-20 wrench and remove the first screw on the lower top panel. The with the T-15 wrench remove the top center and top back screw as shown below.



4.-Next with a small screwdriver unclip the gas spring. And lay down on the saddle bag door. Then with the T-20 wrench remove all side panel screws around the saddle bag face frame.



5.-Then use some screwdriver our plastic device and pull the side panel lose. Just pull lose so the top back corner is exposed.



6.-Locate the backup camera main plug. It has a false end in grey as shown below. Then using a screwdriver our plastic pushpin puller, pry apart the two connectors by lifting the tab as shown below to separate the plugs. Discard the plastic dummy plug. This will leave the main plug to use shown.

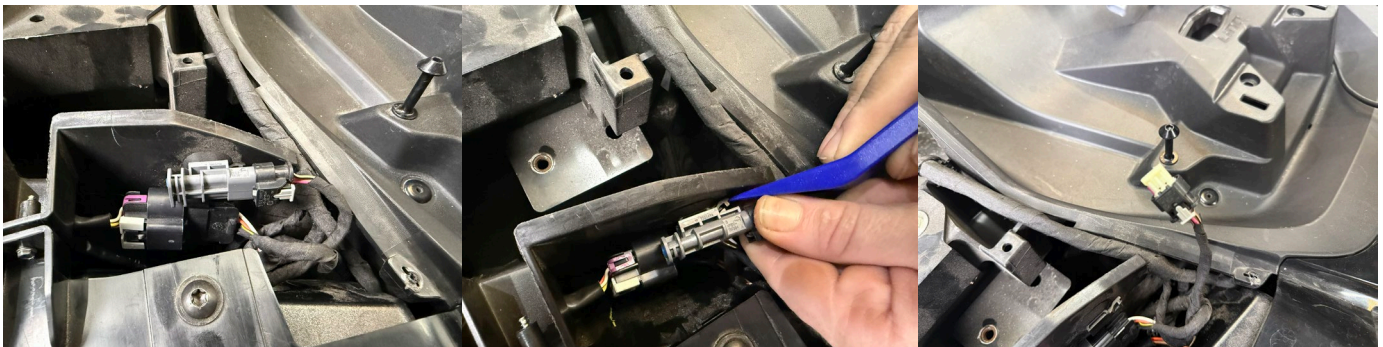

7.-Next take the 7/32 socket and unscrew the single bolt that holds the rear panel in place. Once removed take your hand as shown below and pull back on the rear light cover. Open it up about 4”.



8.-Next take the supplied alcohol pad and clean the surface center above the license plate. This is where the camera will mount. Next take the camera wire and run it between the plastic cover and the license plate light fixture. Use your left hand to reach back behind and pull the wire through.



9.-To make sure the camera direction is correct the camera bracket as shown below should be able to tilt downward. Locate the camera center on your license plate as shown and stick the camera firmly in place. You can then tilt the camera up or down for best viewing.



10.- Run the wiring harness from the camera to the connector location. Then take the supplied connector cable and plug the camera into the red plug making sure to align the arrows and then connect the main connector as shown below. Notice the connection to properly fit the plug. Push in to lock in place.

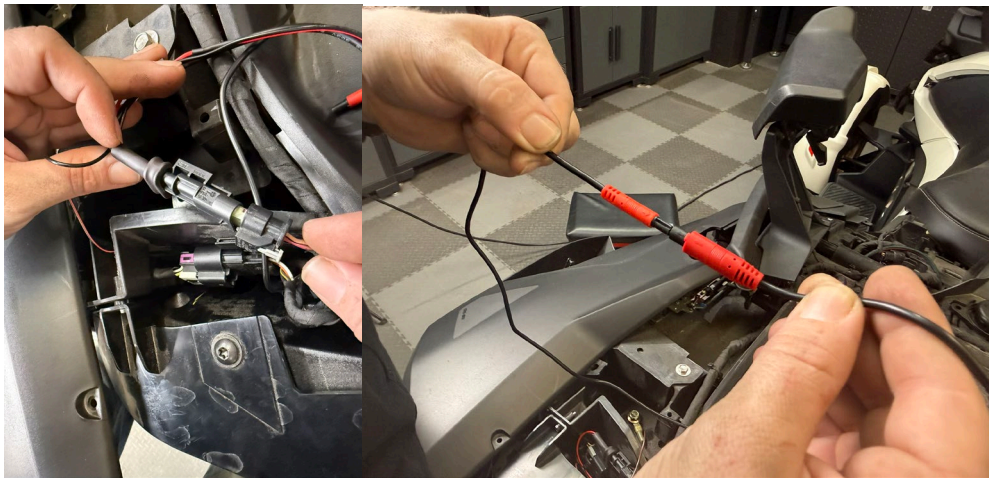

11.- Take the supplied 8mm bolt and secure the ground to the metal OEM plate using the 10mm socket. Tighten down.



12.- Take the supplied two wire ties and bundle up the wiring harness to the existing harness and then the rest at the end together as shown below tucked away. If the new male connector is difficult to install over the female socket take a knife and make the guide slot in red below on the female about 1 1/6" wider. This will allow a better alignment of the guide slot and the tab hanging down on the inside of the male housing to align the two connectors.

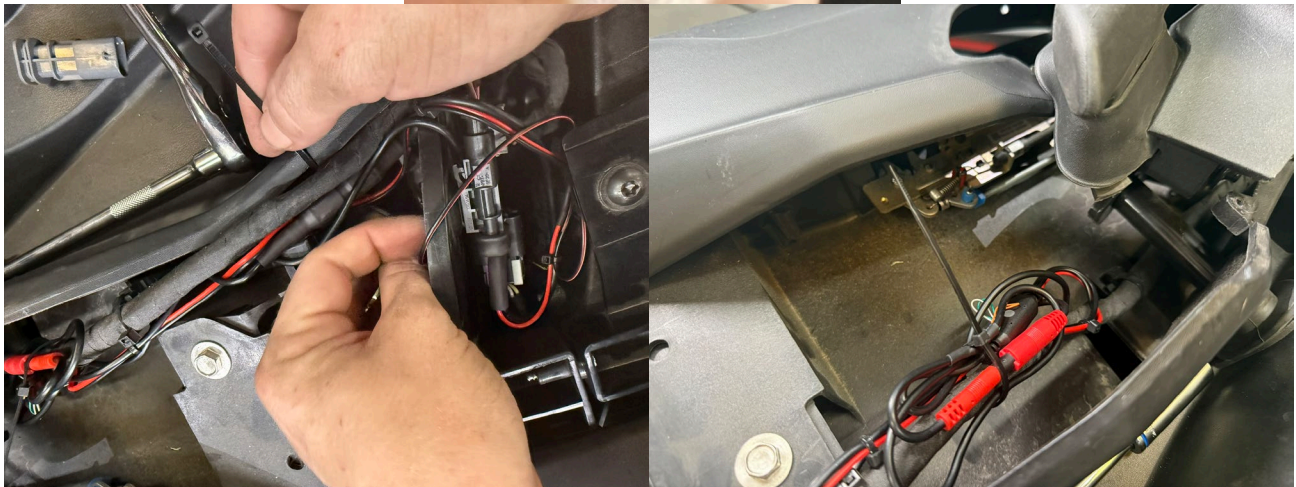

13.- At this point you must test the system by starting your Spyder and placing it in reverse. You should see a screen picture such as this below. If the screen shows the rear view, you are ready to reinstall the spyder.

NOTE: Some models of 2024+ Spyders as we have discovered, the OEM harness Positive and Negative Video feed wires are reversed, not allowing the video feed to be shown on the screen. When testing if this is the case take the supplied cross cable and disconnect the quick connector shown circled in red below and plug in the cross cable to correct the factory mistake. Then retest to make sure the screen shows the image. Then take the supplied heat shrink and cover the cable connection, using heat, like a heat gun or equal, shrink it down to secure.





14.- Slide the side panel back over in position. Be sure to lift it up over the rear top rail. Reinstall all T-15 screws and T-20 screws back in reverse as you removed them. Snap the gas spring back over the ball stud.

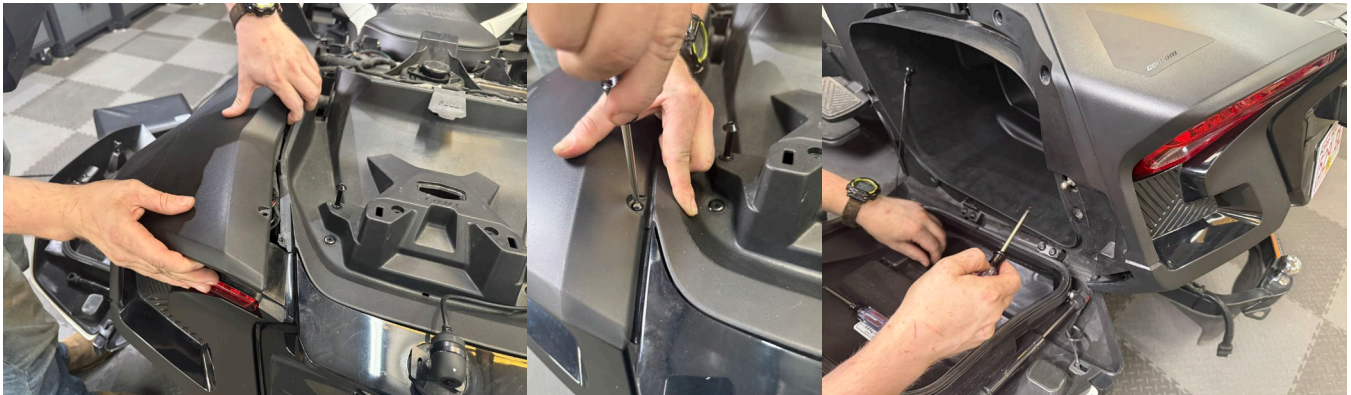

15.- Once all screws are back in position, take the passenger seat, plug it in and reinstall the seat either before or after installing the trunk.



16.- Take the rear trunk, place it in its general location and plug in the main connector for the trunk. Then take the trunk tilted up and align the two side legs with the cross bar each side and at the angle push in place and then lower. Push the trunk down into its place and make sure the back of the trunk below the lower section is latched as you unlatched before. Then take the OEM key inside the trunk and relock the cent lockdown by turning clockwise the center lock. Your New Backup Camera is now installed!

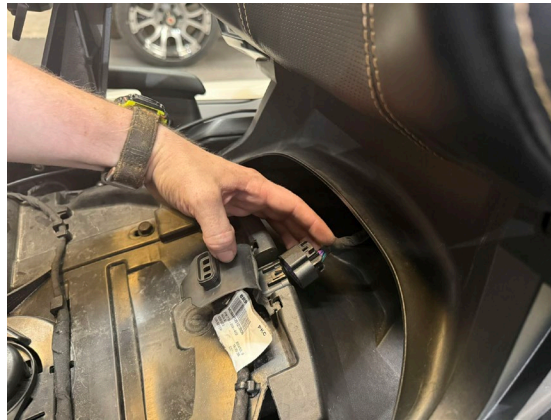

We thank you for purchasing our 2024+ RT, F3 & CANYON backup camera kits. Today we know the need for Quality Accessories, and we have solved that demand with a stylish system that compliments the design of your Spyder®!

spyderextras.com