



Nelson & Nelson Mfg.
5210 Stadium Blvd, Suite C
Jonesboro AR 72404
870-268-6393 : Cell 219-1019

Installation Instructions 4-7-24

Model CAN-1U12ADJ
Patented

Dual 12 volt (2) 2.1 Amp USB Sockets (1) 12 Volt

Steps needed to install your 12-volt power station for 2025+ Canyon Models



1.- Remove the top two socket head bolts from the center steering column using a 7mm Allen wrench or socket. There is a total of 4 bolts remove only the top two bolts. When removing them please keep the two washers from the existing bolts.



2.-With the supplied new socket head bolts and aluminum spacers, place a spacer in each hole on the steering wheel. Be gentle in making sure they stay in position. Take the two new socket head bolts and washers using 8mm Allen wrench, apply medium strength Loctite (Blue Color) to lower ½ of the threads to secure once you tighten down firmly to manufactures specifications.

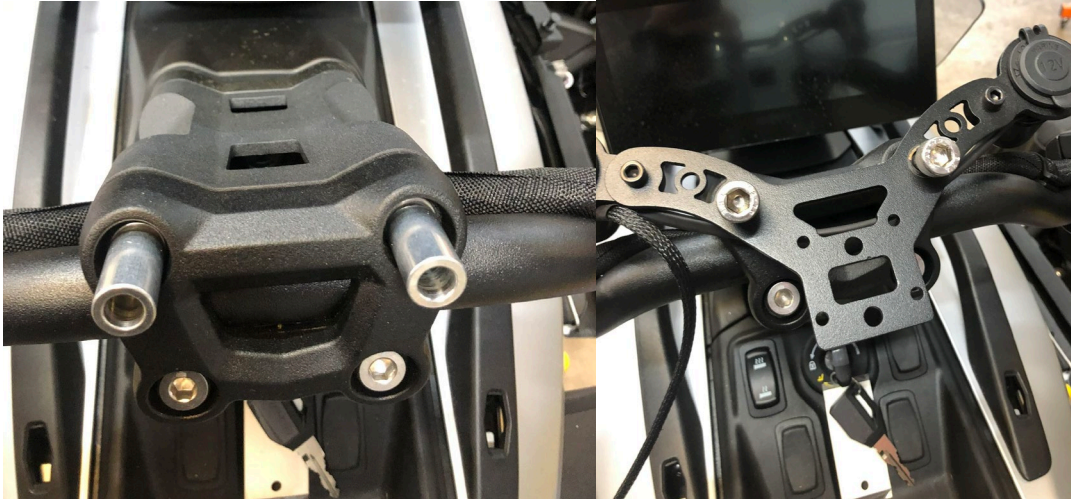

3.-Your Canyon CAN-1U12ADJ, 12-volt power station is pre-wired at the 12-volt sockets. You will need to connect to the accessory plug on the LEFT side aux power supply plug. First remove the panels as shown below. Squeeze in on these two tabs to remove this access panel. Remove the panel. Do the same for the panel on the opposite side.



4.-Next remove the two push pins one on each side as shown below. Then locate the front panel below and remove the two metal keepers and then remove this panel.

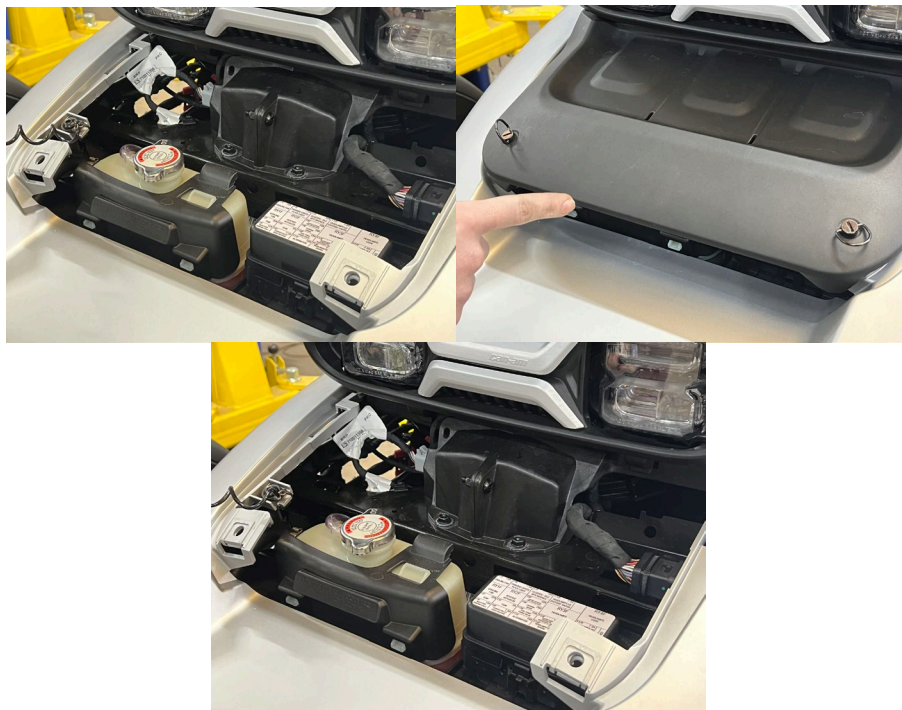

5.- Once the panel is removed then grab the LED headlight case and remove this.

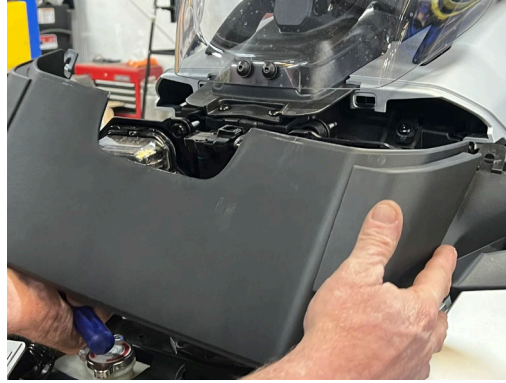

6.- Look inside on as shown and located the factory accessory plug. Once located direct the plug wire through the hole in the plastic as shown.



7.- Take the wiring harness from the docking station and run as shown to this open area. You can see how it runs down the factory harness area on the steering shaft. Clip the harness in the retainer clip from the factory as shown. Then take the supplied Y-Adapter and plug that into your docking station harness and the female end into the factory power plug. This will allow you to still have an additional power plug for future accessories. Your docking station is now installed, and you will need to turn your Canyon on to test the power. The LED lights in the sockets will light up blue.

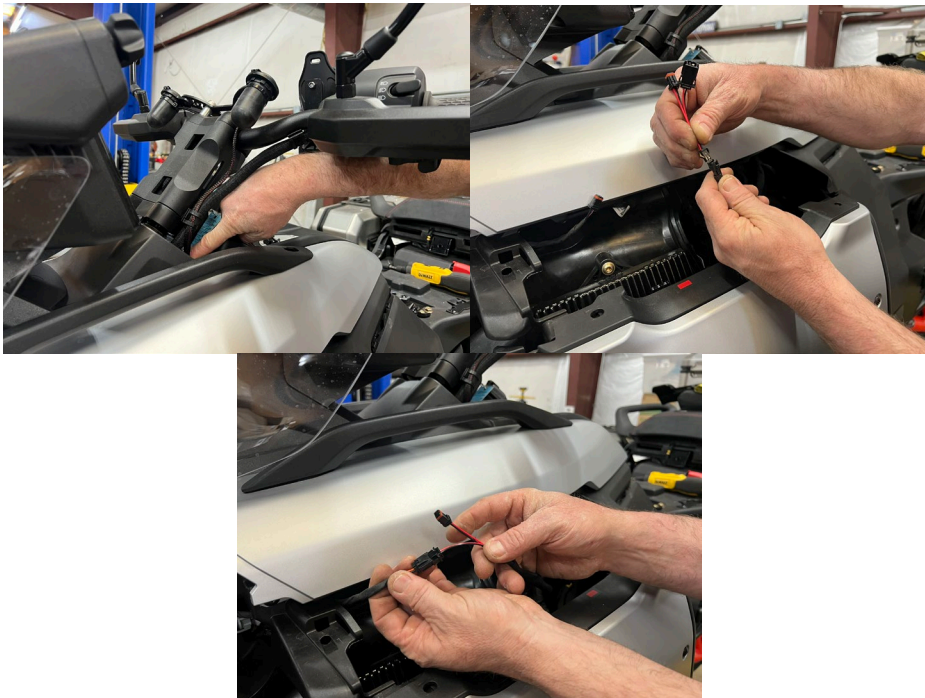

Reinstall all panels in reverse of how you disassembled them.

We thank you for purchasing one of our 12-volt power stations. Today we know the need for 12-volt power for accessories and we have solved that demand with a stylish system that compliments the design of your Canyon®!

spyderextras.com