



Nelson & Nelson Mfg.
5210 Stadium Blvd, Suite C
Jonesboro AR 72404
870-268-6393 : Cell 219-1019

Installation Instructions 3-18-25

Model RYK-TSFL FLASHER
Ryker Trunk & Saddle Bag Safety Flasher Kit

Steps needed to install your SE Performance Ryker Safety Flasher Kit.

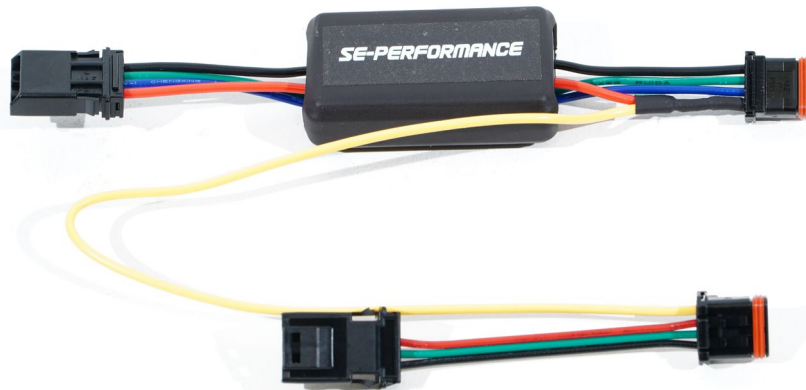

If you are installing the flasher just for the factory taillights only skip down to Number 4.

If you are installing this flasher after you have installed the Trunk & Saddle Bag kit, or a first time install then follow steps below to remove the taillight assembly again.

1.- First Remove the two screws on each side of the rear Led Taillights. The screws are located underside as shown here. This will allow the rear center cover to be removed as shown. Then remove the lower screw from the center plastic panel.

Shown removed here:

2.- Next remove the screw for each rear taillight to remove the light as shown below. Do this for each side. Remove this side panel screw to allow access to the main wiring harness.



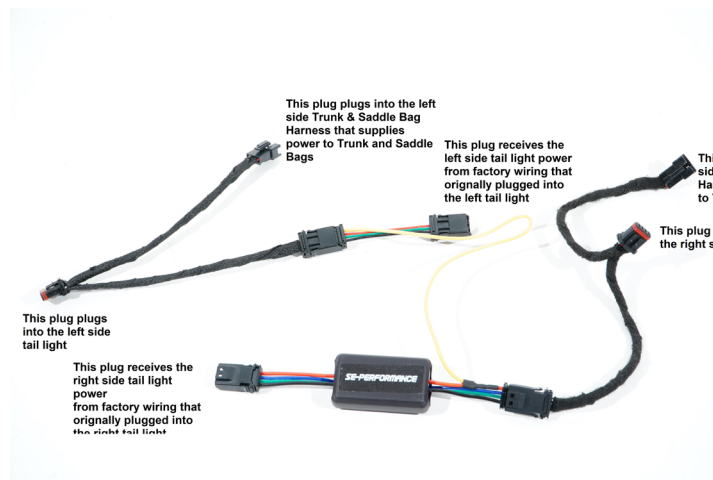

O

3.- Take the two Y-Adapters shown above from the Trunk & Saddle Bag kit and plug both Y-Adapters into the flasher as shown. Install the remaining plugs as indicated in the diagram above to the Left & Right Tails Lights and the Left & Right main harnesses that go to the Trunk and Saddles bags on the Ryker

4.- **Install of flasher on factory taillights only.** Once the wiring harness to the rear taillights are exposed, unplug each taillight main wiring plug. Take the new flasher kit as shown below and plug the socket ends as outlined.

Flasher plug assignment

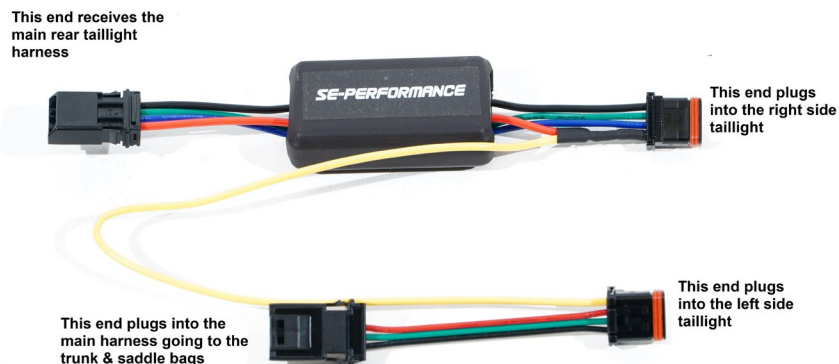

4.- Reinstall the taillights and cover in reverse of how it was removed. Make sure that wires are neatly tucked away and secure. Test your new flasher by placing your foot on the brake. All rear brake lights should flash.

This will provide further protection from behind.

Your Rear Ne Trunk & Saddle Bag Flasher Kit is now installed! Enjoy the NEW level of safety knowing you can be seen by drivers when applying the brakes!