



Nelson & Nelson Mfg.
5210 Stadium Blvd. Suite C
Jonesboro AR 72404
870-268-6393 : Cell 219-1019

Installation Instructions 2-14-23

Model SF3RT-BRPHM

For all F3-T, Limited & RT Models with BRP OEM Trailer Hitch

Steps needed to install your Rear Cooler Rack

DO NOT USE IMPACT DRILL ON BOLTS OR NUTS.



Complete Kit shown above.

1.- First take the rear rack and locate it at the Trailer Hitch as shown below. The area of the hitch where the safety chains would hook is where two main bolts will be located.



2.- Next take the provided spacers as shown below while holding the rack up below the Hitch place the spacers in the slot shown below. Next take the 5/16" flanged bolt and place it through the spacer with washer and locknut on bottom side. Do not tighten up at this point. Do the same for the Right side.

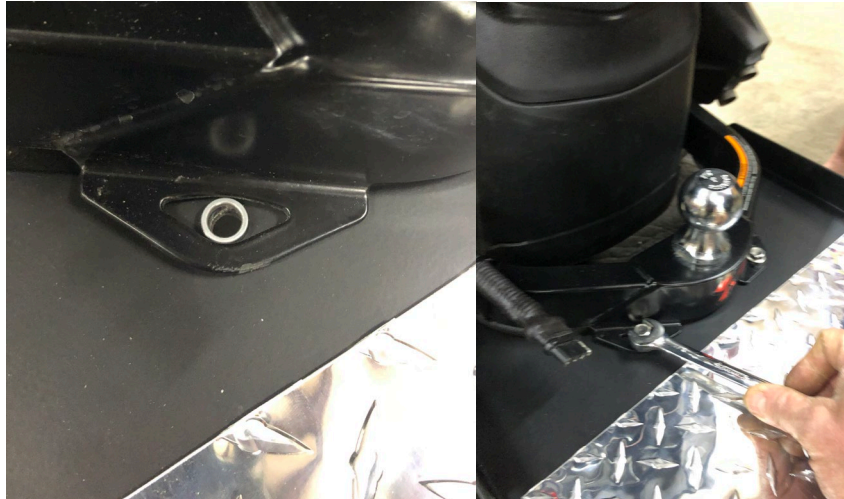

3.- Then take the left rear hanger bracket place over hitch frame as shown below. Locate and line up with the rear rack mounting hole. Take the black carriage bolt and place through the bracket as shown with the washer and locknut on the underside. Do not tighten up. Do the same for the Right-Side bolt. Once all bolts are installed tighten down the Flange Head bolts first making sure to adjust the racks alignment with the center of the Spyder. Once tightened then do the same for the rear bolts. This is a very strong connection to your hitch.



4.- Your Hitch is now installed. See Spyder Extras site for Cooler Options!
This Rack is designed to easily be removed so you can use your trailer.



We thank you for purchasing one of our F3 / RT Accessories. Today we know the need for accessories that provide a higher level of comfort while riding and we have solved that demand with a stylish system that compliments the design of your Spyder!

Spyderextras.com